



2023 WOMEN'S AGRICULTURAL LEADERSHIP CONFERENCE

STERLING HISTORY: EMPOWERING LEADERS FOR 25 YEARS

Minnesota Landscape Arboretum | 3675 Arboretum Drive, Chaska, MN

NAME:

Innovator Sponsorship Partner



Major Sponsorship Partners



WOMEN'S AGRICULTURAL LEADERSHIP CONFERENCE 2023

Celebrating 25 Years Women's Agricultural Leadership Conference

For 25 years, our agricultural leadership conference and network have focused on the integral roles women play in agriculture.

In 1998, Robin Kinney and Doris Mold decided that something needed to be done to activate more women in agriculture. Gathering other like-minded women to help, they launched the first Women's Agricultural Leadership Conference, "Making Our Place in the World," in 1999.

Now it's 2023, and we are celebrating 25 years of quality programming, networking, and leadership development offered through this annual conference and our quarterly Women's Ag Leadership Network (WALN) events. We're also proud of our collaborative partnership with the Cultivating Resiliency for Women in Agriculture program to offer stress reduction opportunities geared toward the unique needs of farm women and women in agriculture.

This is also our 21st year of honoring outstanding agricultural mentors. This award recognizes those who have been positive mentors and role models for people in agricultural fields, especially women. Mentors play an integral role in the development of our agricultural leaders and they often go unheralded. We're excited for our 2023 award winners to join the other 84 outstanding mentors we've celebrated over the years. As we move into the next 25 years, watch this space for exciting new efforts in our Women's Agricultural Leadership Programming!

2023 COMMITTEE MEMBERS

The conference planning committee is entirely volunteer-driven and involves members from all walks of agriculture.

Katala Anderson

Jill Brindamour

Ashley Craft

Sarah Dornink*

Amanda Durow*

Caitlin Keck*

Emily Krekelberg*

Mackenzie Lewis

Isabelle Lindahl

Jamie Logsdon

Doris Mold (Co-Founder)*

Kim Neumann

Sam Schwoeppe

Carrie Stowers

Greta Tank*

Sue VonBank*

**Indicates 5+ year committee volunteer*

*Intern: **Kyle Thomas***

*Graphic Designer: **Molly VanBrocklin**
(behance.net/offtheorbit)*

*If interested in joining the WALC
planning committee, contact*

***Doris Mold** at doris@sunriseag.net.*



**WANT TO CONTINUE NETWORKING
WITH AMAZING WOMEN?
Attend WALN's In-Person Networking Event!**

MAY 16 @ 6PM

Axel's Restaurant

2540 Cleveland Ave N · Roseville, MN 55133

Check out the QR Code above to stay up to date on the May 16th Networking Event!

Follow us on social media to learn more about future in-person and virtual networking events as well as a fair weather farm/agricultural tour!



Like our page
on Facebook
[/womensagleadership](https://www.facebook.com/womensagleadership)



Follow us
on Instagram
[@womensagleadership](https://www.instagram.com/womensagleadership)



Use the hashtag
#WALC2023 on Twitter
[@womensaglead](https://twitter.com/womensaglead)



Check out our
Website at:
[womensagleadership.org](https://www.womensagleadership.org)

CONFERENCE SCHEDULE | WEDNESDAY, APRIL 12, 2023

7:45-8:30AM

Registration and Networking

8:35AM

Welcome: Natalie Beckendorf, MN FFA State Vice President
Emcee: Amanda Durow, Vice President, CoBank ACB

8:45AM

General Session: *Making our Future Sterling*
Christine Leonard, Owner, The Greater Good LLC/Dairy Farmer
Janelle Skibicki, Senior Vice President Human Resources, AgCountry Farm Credit Services
Madilyn Smith, Undergraduate Student, University of Minnesota
Andrea Vaubel, Deputy Commissioner, Minnesota Department of Agriculture
Roundtable Discussion by Conference Participants

10:00AM

Break and Networking

10:10AM

Breakout Session I

11:15AM

Mentoring our Future: *Featuring past Mentoring Award Winners showcasing their perspectives and impact.*
Emily Krekelberg, Extension Educator, Farm Safety & Health, University of Minnesota
Sheryl Meshke, President and CEO, Associated Milk Producers, Inc.
Juanita Reed-Boniface, Educational Consultant, Agvocate, Author & Partner Boeckenhauer Cattle
Moderator: Doris Mold, Conference Co-Founder

12:00PM

Luncheon Program

Greeting: Doris Mold, Conference Co-Founder
Remarks: Thom Petersen, Commissioner, Minnesota Department of Agriculture
21st Annual Agricultural Mentoring Awards: Honoring outstanding mentors in agriculture

1:25PM

Speed Networking

2:00PM

Breakout Session II

2:55PM

Break and Networking

3:10PM

Mini Sessions: *Roundtables on different topics*
Stay abreast on industry issues, new ideas and the next big thing on a wide range of topics.
Take part in up to three 14-minute mini-sessions. Multiple sessions occur simultaneously, creating substantial energy.

4:00PM

Adjourn

4:30PM

***Optional Reception* Continue the Conversation – Farm at the Arb**

We'll discover the past, present and future of agriculture, tour the historic Red Barn and Minnesota crop plots while continuing conversations from the conference! Also, **be the first to preview the newly opened Burton and Virginia Myers Education Center** where education and horticulture intersect, showcasing University of Minnesota research on growing food and demonstrating the importance of the plant-to-plate story.



Like our page
on Facebook
[/womensagleadership](https://www.facebook.com/womensagleadership)



Follow us
on Instagram
[@womensagleadership](https://www.instagram.com/womensagleadership)



Use the hashtag
#WALC2023 on Twitter
[@womensaglead](https://twitter.com/womensaglead)



Check out our
Website at:
[womensagleadership.org](https://www.womensagleadership.org)

BREAKOUT SESSIONS

BREAKOUT I: 10:10 am – 11:00 am

MacMillan Auditorium

View on the 2023 Farm Bill

Agriculture's Super Bowl will take place again this year - the writing of the Farm Bill. Come to this session to hear from experts on the creation of the farm bill, the politics behind its development, and what changes we may see out of the final legislation.

Amber Glaeser, Director of State Government & Industry Affairs, Land O'Lakes, Inc.

Staci Martin, Director of Government Relations, AgriBank

Lauren Servick, Director of Marketing & Public Policy Engagement, Minnesota Pork

Moderator: Mackenzie Lewis, Relationship Manager, CoBank ACB

Azalea Classroom

Continuous Improvement in Agriculture

Join Laura for an overview of the learn, practice, apply, and teach method used to build a Lean continuous improvement culture at a global fortune 100 agricultural company.

Laura Connolly, Continuous Improvement Manager, CHS Inc.

Snyder Auditorium

Emotional Intelligence: Using Uncertainty for Success

Change can create uncertainty. Uncertainty can create fear. The emotions involved are part of the human experience. Attend this interactive session to learn how to use emotional intelligence to turn uncertainty into your advantage.

Dr. Marya Wilson, PhD, Principal, MW Advising

Snyder Classroom I

Taking Your Ag Knowledge Global as an Expert Volunteer Consultant

Want to use your expertise to help a farmer or ag business in a developing nation succeed? Looking for an adventure that's personally satisfying and provides meaningful career development? Whether you're a crop or livestock producer, an agriculture finance professional or a marketing whiz, the USAID-funded Farmer-2-Farmer program has an opportunity for you. Lani will share her experiences with nearly a dozen assignments in Africa and Eastern Europe and lead a conversation about the two-way value of sharing your knowledge internationally.

Lani Jordan, Principal, Lani Jordan Strategic Communication

Fireplace Room

FarmHer Nutrition: Fueling Ourselves to Be Better

As hardworking individuals, we need to be filled up in order to pour out and give of ourselves. One piece of ensuring we are operating at our best is by ensuring we are fueling ourselves. Fueling ourselves to be better includes gut health, hormones, eating for our cycle, and exercise nutrition.

Kennedy Youngren, MS, RDN, LD, Registered Dietitian, The Legendairy Dietitian

BREAKOUT II: 2:00 pm – 2:50 pm

MacMillan Auditorium

Bloom Where You Are Planted

Join Robin as she discusses embracing change, planting seeds of opportunity, empowering others, and saying YES to making a difference in the lives of others.

Robin E. Kinney, Director, Membership & Marketing, Minnesota Farm Bureau Federation

Azalea Classroom

Ag and Fertilizer Market Update

If the last few years have proven anything, it's that we all live in extremely volatile times and the ag marketplace is no different. Crystal talks on the current state of the ag markets, an outlook focusing on corn, soybeans, and wheat, and the driving forces behind the phosphorus and potassium (P&K) fertilizer markets.

Crystal Carpenter, Market Analysis Manager, The Mosaic Company

Snyder Classroom

Navigating Small Business in Rural America Post Covid

As a small business owner living in a small town, a lot has changed since the historical year of 2020. Working through the pandemic, Lindsey talks on what has changed her business structure. The challenges, both good and bad. What she is doing to swing with the punches and capitalize on the new opportunities on the horizon. Come check out her story of butchering through the pandemic and have a good laugh at the adventures that came with it!

Lindsey Fulton Loken, Owner, Blondie's Butcher Shop

Snyder Classroom I

Expand Your Reach Through Podcasting

Starting a podcast can be a daunting task, but a great way to bring value to your customers or consumers. In this session, we will cover questions you should ask yourself when considering if a podcast is right for you, the steps to starting a podcast, and some key strategies to seeing organic growth in your audience. There is never a silver bullet for marketing success, but maybe a podcast could be a part of your arsenal.

Katie Schmitt, Outreach Specialist, Council on Dairy Cattle Breeding

Fireplace Room

Busting Burnout

What is burnout and why does everyone suddenly care about it? Burnout impacts everyone, especially the most highly engaged employees. This session will explore the causes of burnout, its impacts on our mental well-being and strategies for talking about it.

Emily Krekelberg, Extension Educator, Farm Safety & Health, University of Minnesota Extension



Like our page
on Facebook
/womensagleadership



Follow us
on Instagram
@womensagleadership



Use the hashtag
#WALC2023 on Twitter
@womensaglead



Check out our
Website at:
womensagleadership.org

MINI SESSIONS

70th Anniversary of Farm Business Management

Join this mini session for an overview of Farm Business Management and a short history celebrating 70 years of FBM.

Megan Roberts, Executive Director, Minnesota State Southern Agricultural Center of Excellence

Jennifer Smith, Farm Business Management Instructor, Riverland Community College

Annie's Project: Networking Women in Production Ag

Annie's Project is a national program for farm women which introduces you to the 5 Risk Management Areas of Agriculture, production, financial management, human resources, marketing and the legal field. Join us for a fun budgeting exercise and introduction to Annie's Project celebrating 20 years in 2023.

Colleen Carlson, University of Minnesota Extension, Annie's Project State Coordinator

Crop Insurance: Risk Management for Your Farm

Learn about the types of crop insurance and risk management available for producers. We will discuss the variety of insurance available, important factors when making your decision and how using crop insurance will create a strong risk management plan for your farm.

Rachel Molitor, Insurance Officer, Compeer Financial

Continue the Discussion Emotional Intelligence: Using Uncertainty for Success

Change can create uncertainty. Uncertainty can create fear. The emotions involved are part of the human experience. Attend this interactive session to learn how to use emotional intelligence to turn uncertainty into your advantage.

Dr. Marya Wilson, PhD, Principal, MW Advising

Farmer Veteran Coalition of Minnesota

Join the conversation with Rachel and Shelly as they discuss the mission and goals of this new chapter of the Farmer Veteran Coalition. They will share how the coalition will be working on these goals and how their first year has gone.

Rachel Connell, Secretary, Farmer Veteran Coalition of Minnesota
Shelly Woods, President, Farmer Veteran Coalition of Minnesota

Food Insecurity in America's Heartland

It's common to hear, "Iowa feeds the world," but what about our food insecure neighbors? Food insecurity doesn't have a look or a uniform -- it's our friends, co-workers, and neighbors. Learn what food insecurity is, how it affects our most vulnerable populations, and learn more about what Food Bank of Iowa is doing to end hunger in Iowa.

Emily Shearer, Food Acquisition Manager, Food Bank of Iowa

From the Sandhills to the Big City: A Book Writing Adventure

A Christmas gift of the StoryWorth program provided the spark to "get serious" about writing memoirs. The structure of writing a story every week resulted in 52 stories tracing life highlights "From the Sandhills to the Big City." Organized around eight themes, the stories reflect the impact of her early roots as "a child of the prairie" and the livestock industry. In this session, Juanita will share her journey of writing, editing, publishing and marketing along with highlights of selected stories.

Juanita Reed-Boniface, Consultant in Agriculture Literacy & Advocacy

Growth of Minnesota FFA Association

Come learn more about the growth and expansion of Minnesota FFA to more than 200 chapters with nearly 16,000 student members.

Natalie Beckendorf, Vice President, Minnesota FFA Association

Lavynne Rada, Interim Executive Director, Minnesota FFA Association

How Women in Ag can Get Ahead of the Curve with Government Relations and Technology

Join this session to get a better understanding of the complex strategic relationships that involve the House and Senate Agriculture Committees who are charged with overseeing the U.S. Commodity Futures Trading Commission (CFTC). Some of the key examples include blockchain technology, wealth creation, and why women are standing at an inflection point with a great opportunity to innovate and change the agriculture industry.

Tiffany Kovaleski, Founder/CEO, KÖVALITION



Like our page
on Facebook
[/womensagleadership](https://www.facebook.com/womensagleadership)



Follow us
on Instagram
[@womensagleadership](https://www.instagram.com/womensagleadership)



Use the hashtag
#WALC2023 on Twitter
[@womensaglead](https://twitter.com/womensaglead)



Check out our
Website at:
[womensagleadership.org](https://www.womensagleadership.org)

MINI SESSIONS

Leadership and Learning with Minnesota Farm Bureau

Minnesota Farm Bureau amplifies the voice of farmers and agriculturists through engagement, grassroots advocacy, and agriculture awareness. Learn about the latest opportunities in these areas, including leadership for all ages and resources for promoting agriculture.

Pam Debele, Education Coordinator, Minnesota Farm Bureau
Rachael Peterson, Leadership Coordinator, Minnesota Farm Bureau

Let's Talk Carbon

Minnesota Farmers Union, in partnership with Farmers Legal Action Group, and the Minnesota Department of Agriculture, released a "Farmers' Guide to Carbon Markets in Minnesota" earlier this year. With one-fifth of the world's largest companies setting net-zero emission targets, farmers are being asked to make changes. Join Anne and Ariel to talk about carbon contracts, climate-smart agriculture, and how farmers are responding to climate change.

Ariel Kagan, Climate & Working Lands Director, Minnesota Farmers Union

Anne Schwagerl, Vice President, Minnesota Farmers Union

Managing Employees and Talent

We all want to be great leaders, managers, and mentors to the people who rely on us in our organizations. We'll discuss a variety of management areas starting with some basic areas of influence, goal communication, employee development discussions, and delivering performance feedback.

Marguerite Winter, Senior Human Resources Manager, broadhead

Master Your Inner Monologue

In this mini session, participants will learn four strategies to improve the way we talk to ourselves. Improving self-talk is key to helping us achieve goals, feel life satisfaction, and experience meaningful relationships. Be your own best advocate vs. your own worst enemy!

Monica McConkey, Ag Mental Health Counselor, Eyes on the Horizon Consulting, LLC

Over-the-counter Antibiotics are Going Away; Are You Ready?

Starting June 11, 2023, over-the-counter antibiotics will only be available as a prescription product. Dr. Armstrong will discuss what livestock producers need to be ready for the transition and how it will impact the livestock industry

Joe Armstrong, DVM, Cattle Production Systems Extension Educator, University of Minnesota

The Power of Dairy Cattle Genetics

Our understanding of dairy cattle genetics is always evolving thanks to dairy producers, agribusinesses, and the Council on Dairy Cattle Breeding (CDCB). Learn more about the work and research being done by CDCB, the organization responsible for U.S. dairy cattle genetic and genomic evaluations and the stewards of the national cooperator database of phenotypic and genomic data – the world's largest animal database.

Katie Schmitt, Outreach Specialist, Council on Dairy Cattle Breeding

What's Halal Slaughter & Why Should I Do It?

Hear from Rebecca about what halal slaughter is, the process, the market for halal in Minnesota, and the unmet demands. Highlighting her business experience as owner of Clean Chickens and Co. Finally, we'll discuss the value of halal certification on your products.

Rebecca Wierschke, President & Owner, Clean Chickens and Co. LLC

What's Happening in Minnesota 4-H?

Minnesota 4-H is full of amazing opportunities for youth! Learn about the exciting agriculture events and activities available, plus the many other ways 4-Hers can learn new things!

Meg Clark, State Ambassador Coordinator, Minnesota 4-H
Sarah Fisher, Agriculture Ambassador, Minnesota 4-H
Evelyn Otto, State Ambassador, Minnesota 4-H

When Social Media Goes Wrong

Krishona established the popular UMN Extension Horse Facebook page in 2010 to disseminate research-based information to horse owners and professionals. The page grew to over 25,000 followers and averaged an annual reach of 2.7 million people. In December 2022, hackers gained ownership of her personal page and the UMN Horse page. The goal of this session is to highlight the top 10 lessons she earned which can help others prevent and respond to a hack of a Facebook page.

Krishona Martinson, Professor & Equine Extension Specialist, University of Minnesota



Like our page
on Facebook
[/womensagleadership](https://www.facebook.com/womensagleadership)



Follow us
on Instagram
[@womensagleadership](https://www.instagram.com/womensagleadership)



Use the hashtag
#WALC2023 on Twitter
[@womensaglead](https://twitter.com/womensaglead)



Check out our
Website at:
[womensagleadership.org](https://www.womensagleadership.org)

SPEAKERS

Joe Armstrong, DVM, cattle production systems extension educator at University of Minnesota, graduated from the University of Minnesota - College of Veterinary Medicine in 2015. After veterinary school, Joe worked as a private practitioner with beef and dairy farms at Anderson Veterinary Service in Zumbrota, MN. Currently, Dr. Armstrong is the Cattle Production Systems Extension Educator, where he focuses on beef and dairy producers.

Natalie Beckendorf, vice president of the Minnesota State FFA Association, hails from the Renville County West FFA chapter. She is a freshman at the University of Minnesota majoring in Ag Communications and Marketing. Natalie's FFA mission for the past year is to be a catalyst to help others discover their passion, fuel their excitement, and provide accountability. Outside of FFA, you can find Natalie showing goats, watching "The Bachelorette," and laughing with friends and family.

Colleen Carlson, Annie's Project state coordinator and UMN extension educator in Scott and Carver Counties, was raised on a crop and livestock farm in Le Sueur County and lives on a farm in Waseca County where she, her husband, and 3 sons raise beef, hogs, chickens, and rent crop ground. She has a degree in Ag Education from the University of Minnesota.

Crystal Carpenter, market analysis manager with The Mosaic Company, is covering fertilizer, agriculture, and macroeconomic markets. After obtaining her master's degree in Agricultural Economics from Michigan State University, Crystal served as a VP of agribusiness consulting at Informa Economics (now S&P Global), providing analytic and strategic planning services for agriculture and bioenergy clients for over 10 years. Following Informa, she served as a market analyst within CoBank's Knowledge Exchange division covering specialty crop markets.

Meg Clark, state ambassador coordinator, Minnesota 4-H, loves to educate people about agriculture and where their food comes from. She grew up on a dairy and crop farm and has a bachelor's degree in Animal Science with a Dairy Production emphasis from the University of Minnesota-Twin Cities.

Rachel Connell, secretary at Minnesota Farmer Veteran Coalition, is a mom of three, wife to an Army Veteran, cattle rancher, and published author.

Laura Connolly, continuous improvement manager at CHS Inc., is based in the Twin Cities and has over 12 years of experience in the Agricultural industry. She has served as Lean continuous improvement professional and change agent in both the agriculture and construction industries, applying Lean concepts to increase efficiencies and employee engagement across various teams.

Lindsey Fulton Loken, owner of Blondie's Butcher Shop in Wamamingo, MN, is an ag-vocate for agriculture, public speaker, mom, and a full-time butcher. National Geographic will be featuring her article "Covid in the heartland and how it affected the food supply". Lindsey loves to teach and give tours of her locker to bridge the gap between the producer and the consumer. Her butcher shop is all a vibe as it is hot pink and completely the opposite of any locker you

have ever seen. With a sense of humor and a gaudy amount of pink, you will be entertained through Lindsey's business transitions and working her way through the world of butchery.

Pam Debele, education coordinator for the Minnesota Farm Bureau, works on the leadership development and Foundation teams focusing on promotion and education.

Amanda Durow, senior relationship manager at CoBank, focuses on supporting the capital needs of agribusiness, dairy, and animal protein companies. She holds a BS in Animal Science and an MBA from the University of Minnesota. She and her husband are fifth generation crop and dairy farmers.

Sarah Fisher, agriculture ambassador with Minnesota 4-H, is serving her second term as a Minnesota 4-H Agriculture Ambassador from Martin County and is currently a senior in high school.

Amber Glaeser, director of state government & industry affairs at Land O'Lakes, Inc., joined the government relations team in October after a ten-year career at Minnesota Farm Bureau, most recently as Director of Public Policy. Prior to Farm Bureau she worked for AgriBank on the Government Affairs team. A farm girl from southern Minnesota, she has a bachelor's in political science and communication studies from Gustavus Adolphus College. Amber lives in Lakeville with her husband and two little boys.

Lani Jordan, principal at Lani Jordan Strategic Communication, is an organizational communications consultant that has helped agribusinesses, associations, entrepreneurs, and small-holder farmers. Jordan spent much of her career as the communications lead for CHS Inc. She has traveled to all 50 states and over 45 countries, including USAID-funded Farmer-to-Farmer and other assignments in Moldova, Malawi, Ghana, and Tunisia, working with agricultural cooperatives, farmers, government, and financial institutions.

Ariel Kagan, climate and working lands director at Minnesota Farmers Union, has a background centered around agricultural economics and policy. She's spent her career working at the intersection of agriculture, sustainability, and community resilience, working to support farmers, climate resilience, and policy development.

Robin E. Kinney, director of membership & marketing at the Minnesota Farm Bureau Federation, leads a team who work across the state to guide county programs, engage members, and advocate for agriculture. Her previous work experience includes NCBA, American Farm Bureau, and Assistant Commissioner for the Minnesota Department of Agriculture from 2007-2011. Born and raised a city girl in the Twin Cities, she turned country in 1972 and is grateful every day for the move to the farm and the mentors who helped guide her to a path in agriculture.

Tiffany Kovaleski, founder and CEO of KÖVALITION, focuses on connecting government relations and technology with niche sectors to help intersect unserved populations and wealth creation. Majoring in Philosophy from St. Catherine's, she is passionate about women, equity, and total health for all. Her work experience has given her the lens to see how examining the political circles of influence



Like our page
on Facebook
[/womensagleadership](https://www.facebook.com/womensagleadership)



Follow us
on Instagram
[@womensagleadership](https://www.instagram.com/womensagleadership)



Use the hashtag
#WALC2023 on Twitter
[@womensaglead](https://twitter.com/womensaglead)



Check out our
Website at:
[womensagleadership.org](https://www.womensagleadership.org)

SPEAKERS

are a place to start breaking barriers and educating others. She is a proud Minnesotan and lives in Waconia with her husband, daughter, and son.

Emily Krekelberg, extension educator for farm safety & health at the University of Minnesota Extension, grew up on her family's dairy farm near Le Sueur, MN. Her work focuses on grain bin safety, livestock safety, tractor safety, farmer mental health, and suicide prevention. A passion of Emily's is advocating for wellness in agriculture. She has a BS in Animal Science and a master's degree in Agricultural Education from the University of Minnesota.

Christine Leonard, owner and cheese monger of The Greater Good LLC, is the sixth generation dairy farmer with her parents just outside of Waconia, MN. Their farm is also home to her cheese business, "The Grater Good", where she sources local cheeses and other foods to use in creating cheese boards and teaching cheese education classes.

Mackenzie Lewis, relationship manager at CoBank ACB, is a Minnesota transplant who grew up in central Iowa. She received her BS in Agricultural Business from Iowa State University and a Master's in Finance from Colorado State University Global. Her passion for agriculture was planted in high school, and has grown deeper because of her career and volunteering.

Staci Martin, director of government relations at AgriBank, coordinates the strategic direction of AgriBank's government relations activities. Her career includes roles with Minnesota Farm Bureau Federation and AgStar Financial Services (now Compeer Financial). Post-merger, Staci was connected to Compeer's legislative, client education, and corporate giving programs, and the senior leadership team. She proudly serves as a Minnesota FFA Foundation board member.

Krishona Martinson, professor and equine extension specialist at the University of Minnesota, leads the Extension Horse Program and is known for incorporating technology and social media into her Extension programming. Her successful applied research program focuses on improving horse forage utilization and carcass composting. Krishona also owns and operates Leaning Pine Farm and Martinson Herefords with her family. These entities include horses shown in timed events, registered Hereford heifers, and direct marketing beef to the local community.

Sheryl Meshke, president and CEO of Associated Milk Producers, Inc. was appointed to the role in January 2023 following eight years as co-president and CEO. She holds the distinction of being the first woman to be named CEO of a U.S. dairy cooperative. Meshke currently serves on the boards of the Innovation Center for U.S. Dairy, the National Milk Producers Federation, the U.S. Dairy Export Council, and the Minnesota AgriGrowth Council. She is a fifth-generation farmer, operating a hog and sheep farm near Lake Crystal, MN, with her husband Blake Meshke, son Brent and his wife Leslie. Another son Derek and his wife Tori live in Brookings, SD.

Doris Mold, co-founder Women's Ag Leadership Conference, WALC committee member, co-CEO of Annie's Project, president of Sunrise Agricultural Associates, co-lead for Cultivating Resiliency Project,

Minnesota State Fair Milking Parlor and Moo Booth superintendent, and instructor for MAST International at the University of Minnesota., is a Farmer, Agricultural Consultant, Agricultural Economist, Educator, Ag Advocate, Ag Stress Maven, Connector, 4-H Leader, FFA Mentor, Mom, Partner, and Catalyst. She is passionate about developing agricultural leaders, the future of agriculture, and elevating women in agriculture.

Rachel Molitor, insurance officer with Compeer Financial, is part of a trusted team of insurance agents that are dedicated to providing risk management solutions for both crop and livestock operations. Rachel provides exclusive technology for her clients to make sound risk management decisions based on their own data. Anywhere from row crops, fruits & vegetables, milk, feeder and fat cattle, there is a solution to mitigate risk on your farm and she is here to help!

Evelyn Otto, state ambassador with Minnesota 4-H, is from Wright County and is currently a senior in high school.

Rachael Peterson, leadership coordinator for the Minnesota Farm Bureau, works on the leadership development & Foundation team focusing on leadership and the Young Farmers & Ranchers Program.

Thom Petersen, commissioner of the Minnesota Department of Agriculture, was appointed in January 2019 and reappointed in 2023. Commissioner Petersen is a long-time resident of Royalton Township near Pine City where he lives on a horse farm. From 2002 to 2019, he served as the Director of Government Relations for Minnesota Farmers Union, working on behalf of farmer-members in both Washington, D.C. and St. Paul, MN.

Lavyne Rada, interim executive director at the Minnesota FFA Association, has worked as state staff since 2014. Prior to that, she taught high school agriculture and agriscience.

Juanita Reed-Boniface, consultant in agriculture literacy and advocacy, is a retired Extension Specialist in 4-H Youth Development. She joined her family in Boeckenhauer Cattle and husband Dick Boniface in a consulting partnership focused on agriculture literacy and advocacy. She has led workshops at conferences for women in agriculture, community groups, and volunteer organizations, developed lesson plans for Ag In the Classroom, and edited newsletters. Her latest venture has been writing her book, "From the Sandhills to the Big City."

Megan Roberts, executive director of the Southern Agriculture Center of Excellence, Minnesota State Colleges and Universities, is focused on serving farmers and college students through high-quality, relevant learning experiences. Prior to this post, she was an assistant extension professor on the UMN Agricultural Business Management Extension Team and taught post-secondary agribusiness at South Central College.

Katie Schmitt, outreach specialist for the Council on Dairy Cattle Breeding, has a degree in Animal Science from the University of Minnesota. After graduation, Schmitt spent nearly seven years working for World Dairy Expo in various communication and marketing roles including as Communications Manager. In 2022, she was named a "35-under-35" by Wisconsin Farm Bureau for her work founding and hosting "The Dairy Show", World Dairy Expo's podcast.



Like our page
on Facebook
[/womensagleadership](https://www.facebook.com/womensagleadership)



Follow us
on Instagram
[@womensagleadership](https://www.instagram.com/womensagleadership)



Use the hashtag
#WALC2023 on Twitter
[@womensaglead](https://twitter.com/womensaglead)



Check out our
Website at:
[womensagleadership.org](https://www.womensagleadership.org)

SPEAKERS

Anne Schwagerl, vice president at Minnesota Farmers Union, was elected in 2021, after serving as the MFU State Secretary. She and her husband, Peter, own and operate a diversified grain and livestock operation in Big Stone County, managing nearly 400 acres and growing certified organic corn, soybeans, small grains, and Kernza®.

Lauren Servick, director of marketing and public policy engagement with Minnesota Pork, works with farmers to foster relationships with government agencies and elected officials to develop their understanding of pig farming and farmers' commitment to their pigs, their communities, and our shared environment and natural resources. She also leads the image and sustainability work for the organization.

Emily Shearer, food acquisition manager at the Food Bank of Iowa, graduated from Iowa State University with a bachelor's degree in Fashion Merchandising -- she is still a buyer, she just buys food instead of clothing. She discovered her passion for helping those struggling with food insecurity while volunteering at her local food pantry. Emily has been the food acquisition manager at Food Bank of Iowa for over six years. In her free time, she likes reading, being outside, and hanging with her beautiful maniac son, 2-year-old Mason.

Janelle Skibicki, senior vice-president of human resources at Ag-Country Farm Credit Services, has been working in the Farm Credit system for almost 20 years and loves working for a cooperative dedicated to agriculture and rural America. She holds master's degrees in Business Administration and Management. Janelle's ties to agriculture are lifelong and she and her husband currently raise small grains and row crops in northeastern North Dakota with their two sons.

Jennifer Smith, FBM instructor at Riverland Community College, has been teaching farm business management since 2008. She also taught high school agriculture in Hutchinson and Watertown Mayer.

Madilyn Smith, undergraduate student at the University of Minnesota, is studying Applied Economics, International Agriculture, and Communication. After graduation, she will be attending graduate school to study agricultural labor and immigration. Since growing up on a beef and sheep farm in southeastern Minnesota, she has been involved in a variety of jobs and leadership roles with the National Farmers Union, Fillmore County Journal, World Food Prize, Central Lakes College Ag & Energy Center, RDO Farms, CHS Foundation, and National FFA.

Andrea Vaubel, deputy commissioner of the Minnesota Department of Agriculture, was appointed in 2018 and has been with the MDA since 2013. Her current duties include internal oversight of many core agency functions, including human resources, emergency response, and legal affairs. Previously, Andrea worked for Minnesota Congressman Tim Walz in both Washington, D.C., and Minnesota. She lives in Dakota County with her husband and two kids.

Dr. Marya Wilson, PhD, principal at MW Advising, is an advisor in the areas of disruptive and transformational change. She utilizes knowledge in emotions, trust, grief, and leadership to create individual and organizational success.

Marguerite Winter, senior human resources manager, broadhead, is passionate about staffing, employee development, and helping others achieve career advancement. She is a champion for her company's inclusive and people-centered culture. Marguerite has spent eight years on the Human Resources team at broadhead, who specializes in advertising and public relations for clients in the agriculture, food, and transportation industries.

Shelly Woods, president of the Farmer Veteran Coalition of Minnesota is a wife, mom, grandma, and veteran farmer. She is passionate about many things besides her family. Shelly loves the mission of FVC, and encourages her fellow veterans in their farming ventures.

Kennedy Youngren, MS, RDN, LD, registered dietitian at The Legendary Dietitian, is Minnesota-based and married to a fourth generation dairyman. Kennedy didn't grow up in agriculture, but now takes pride in using Instagram @the.legendairy.dietitian to reach farmHERs and others to teach the ones who feed the world how to better fuel themselves. Her education lies in dietetics and human nutrition with an MS in exercise science & sports nutrition. She believes in fueling farmers as though they're athletes, as they're one of the most physically active professions.

PAST CONFERENCE THEMES

2022: Deep Roots Strong Future

2021: Leading for Change into a New Decade

2020: Dare to Lead: Through Challenging Circumstances

2019: Changing the Agscape

2018: Passion for Progress

2017: Embracing Innovation

2016: Activate Her

2015: Planning Our Future

2014: Lean In!

2013: You Ain't Seen Nothing Yet!

2012: Changing the Face of Agriculture

2011: Telling Our Story

2010: New Perspectives

2009: Activating "Generation Next"

2008: Celebrating the Power of 10

2007: Deciphering Our Future

2006: Re-Defining Agriculture

2005: The Power of Leadership

2004: Breaking New Ground

2003: We are the Strongest Link

2002: Together We Stand

2001: Creating Your Future in Agriculture

2000: Empowering Yourself for the Future

1999: Making Our Place in the World



Like our page
on Facebook
[/womensagleadership](https://www.facebook.com/womensagleadership)



Follow us
on Instagram
[@womensagleadership](https://www.instagram.com/womensagleadership)



Use the hashtag
#WALC2023 on Twitter
[@womensaglead](https://twitter.com/womensaglead)



Check out our
Website at:
[womensagleadership.org](https://www.womensagleadership.org)

MINNESOTA LANDSCAPE ARBORETUM LEON C. SNYDER BUILDING MAP

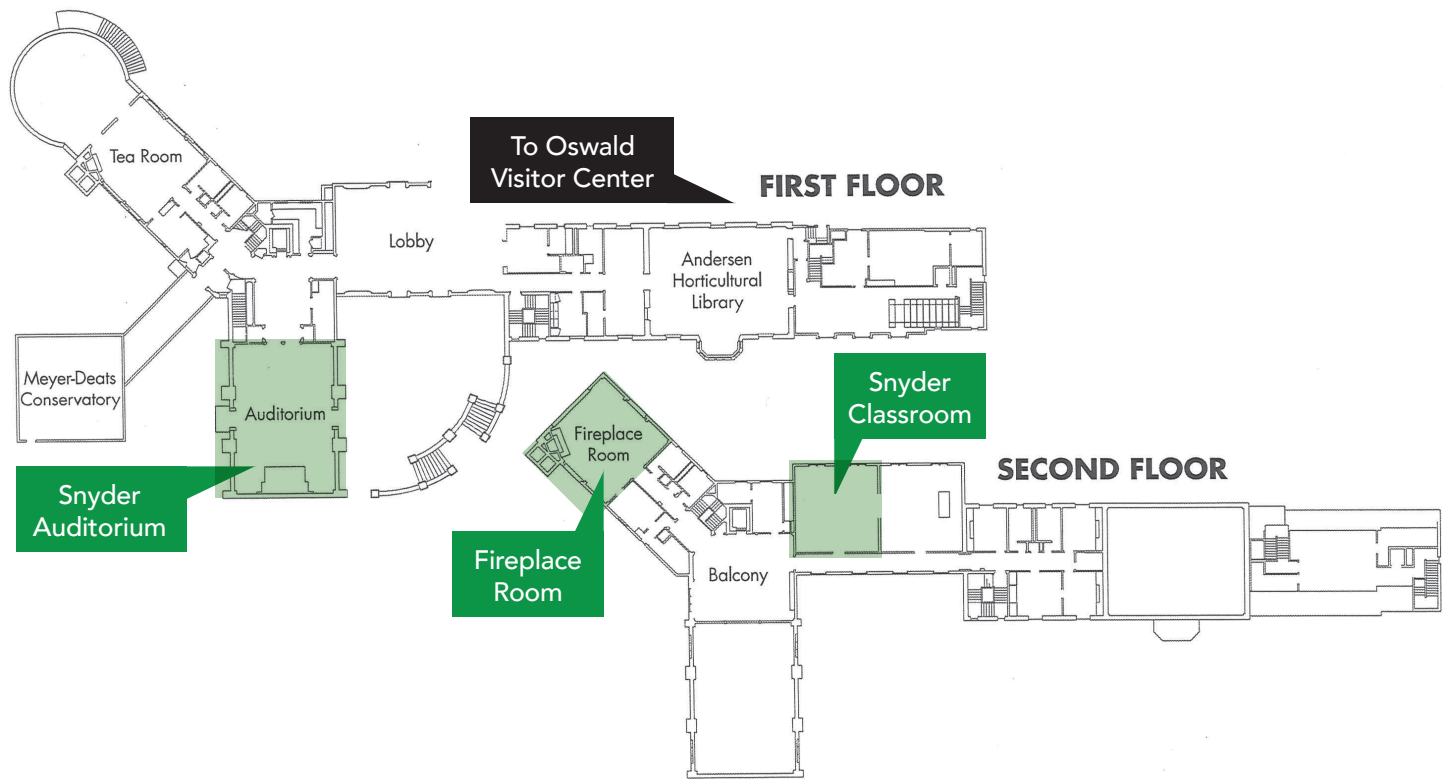

MINNESOTA LANDSCAPE ARBORETUM OSWALD VISITOR CENTER MAP

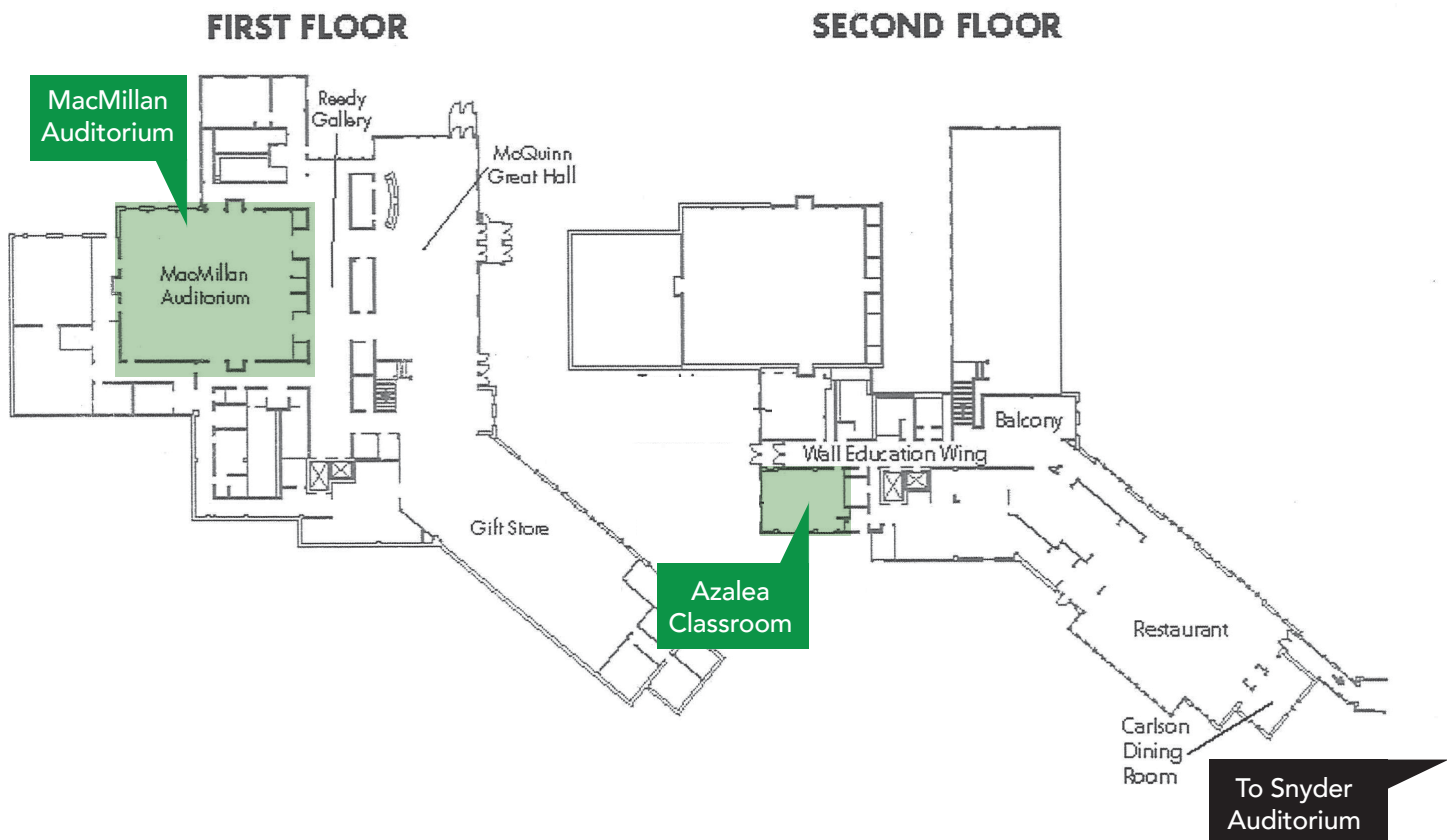

WOMEN'S AGRICULTURAL LEADERSHIP CONFERENCE 2023

BREAKOUT II NOTES:

MENTORING PANEL NOTES:



Like our page on Facebook
[/womensagleadership](#)



Follow us on Instagram
[@womensagleadership](#)



Use the hashtag #WALC2023 on Twitter
[@womensaglead](#)



Check out our Website at:
[womensagleadership.org](#)

WOMEN'S AGRICULTURAL LEADERSHIP CONFERENCE 2023

MINI SESSION:

MINI SESSION:

MINI SESSION:



Like our page
on Facebook
[/womensagleadership](#)



Follow us
on Instagram
[@womensagleadership](#)



Use the hashtag
#WALC2023 on Twitter
[@womensaglead](#)



Check out our
Website at:
[womensagleadership.org](#)

WOMEN'S AGRICULTURAL LEADERSHIP CONFERENCE 2023

3 THINGS I LEARNED:

3 THINGS I WILL DO AFTER THIS CONFERENCE:

3 PEOPLE I MET THAT I WANT TO NETWORK WITH:



Like our page
on Facebook
[/womensagleadership](https://www.facebook.com/womensagleadership)



Follow us
on Instagram
[@womensagleadership](https://www.instagram.com/womensagleadership)



Use the hashtag
#WALC2023 on Twitter
[@womensaglead](https://twitter.com/womensaglead)



Check out our
Website at:
[womensagleadership.org](https://www.womensagleadership.org)

WOMEN'S AGRICULTURAL LEADERSHIP CONFERENCE 2023

NOTES:



Like our page on Facebook
[/womensagleadership](#)



Follow us on Instagram
[@womensagleadership](#)



Use the hashtag
#WALC2023 on Twitter
[@womensaglead](#)



Check out our Website at:
[womensagleadership.org](#)

Thank you to all of our 2023 Sponsors!

INNOVATOR SPONSORSHIP PARTNER



MAJOR SPONSORSHIP PARTNERS



KEY SPONSORSHIP PARTNERS



Thanks for attending!
Please scan this QR
code to take a survey

SPONSORSHIP PARTNERS



2023 Conference Partners

- AgCountry Farm Credit Services
- CoBank
- Compeer Financial
- District 11 Agri-Women
- Doris Mold Agricultural Consulting
- Farm Credit Leasing
- Farm Fresh Designs
- Fresh Flower Designs
- Minnesota Department of Agriculture
- Minnesota Farm Bureau Foundation
- Minnesota Farmers Union
- Minnesota Soybean Research and Promotion Council
- Minnesota State Fair
- Minnesota State Southern Agricultural Center for Excellence
- Sunrise Agricultural Associates, LLC
- U.S. Bank
- Women's Agricultural Leadership Foundation

A BIG THANK YOU TO OUR SPEAKERS, VOLUNTEERS, AND OUR HOST: FARM AT THE ARB!



Like our page
on Facebook
[/womensagleadership](https://www.facebook.com/womensagleadership)



Follow us
on Instagram
[@womensagleadership](https://www.instagram.com/womensagleadership)



Use the hashtag
#WALC2023 on Twitter
[@womensaglead](https://twitter.com/womensaglead)



Check out our
Website at:
[womensagleadership.org](https://www.womensagleadership.org)