



Women's Agricultural LEADERSHIP CONFERENCE

CELEBRATING
24
YEARS

AGRICULTURE 2022
DEEP ROOTS • STRONG FUTURE

CONFERENCE SCHEDULE | WEDNESDAY, APRIL 13, 2022

The Minnesota Landscape Arboretum | 3675 Arboretum Drive, Chaska, MN

7:45-8:30AM

Registration and Networking

8:35AM

Welcome: Nicole Koziolk, State Secretary, Minnesota FFA Association
Emcee: Emily Krekelberg, Extension Educator, University of Minnesota Extension

8:45AM

General Session: *Growing for the Future*
Sarah Dornink, Executive Director, MAELC
Heather Moore, Owner, Moore Family Farms and Moore Local
Corey Scott, Livestock Sustainability Services Leader, Truterra, LLC, Land O'Lakes
Roundtable Discussion by Conference Participants

10:00AM

Break and Networking

10:15AM

Mini Sessions: *Roundtables on Different Topics*
Stay abreast on industry issues, new ideas and the next big thing on a wide range of topics. Take part in up to three 14-minute mini-sessions. Multiple sessions occur simultaneously, creating substantial energy.
Moderator: Jamie Logsdon, Vice President Agricultural Credit Analyst Manager, U.S. Bank

11:20AM

Breakout Session I

12:15PM

Luncheon Program

Greeting: Doris Mold, Conference Co-Founder
Remarks: Thom Petersen, Commissioner, Minnesota Department of Agriculture
20th Annual Agricultural Mentoring Awards: Honoring outstanding mentors in agriculture

1:35PM

Speed Networking

2:00PM

Breakout Session II

2:55PM

Break and Networking

3:10PM

Closing Session: *Ukraine, Russia, Volatile Ag Markets*
Veronica Nigh, Senior Economist, American Farm Bureau Federation
Disruptions in Ukraine's market are having ripple effects across the world. The prolonged absence of Ukrainian products on the global market could lead to food price crises in countries not directly involved in the conflict.

4:00PM

Adjourn

4:30PM

***Optional* Continue the Conversation – Farm at the Arb**
New for 2022! Explore the Arboretum grounds and see the new Farm at the Arb. Visit the historic Red Barn, discover the past, present and future of agriculture, explore Minnesota farm crops and research centers while continuing conversations from the conference!

INNOVATOR
Sponsorship Partner



Thank you to our Major Sponsorship Partners



FARM CREDIT LEASING



BREAKOUT SESSIONS

BREAKOUT I: 11:20 am – 12:10 pm

MacMillan Auditorium

Advancing in your Career Panel:

The Journey from Interns to Executives

Hear three distinct leadership journeys and learn from these experts on what matters most to shape your own journey, what experiences can be the most advantageous and when it's time to shift course.

Natalie Cameron, AVP Credit Officer/RISE Leadership Team Alumni, AgCountry

Mary Kay Delvo, Strategist, Certified Coach & Facilitator, INspiring SIGHT

Ben Hansen, Career Counselor and Interim Associate Director, University of Minnesota Career Services

Jen Webster, Protein Trader, CHS, Inc.

Moderator: Jamie Logsdon, Vice President Agricultural Credit Analyst Manager, U.S. Bank

Azalea Classroom

Navigating Science and Communication Aspects of Sustainable Ag Production

Increase your comfort with engaging in sustainability conversations. Compare and contrast sustainability statements, and dive deeper into the science behind common environmental goals and actions. Leave the workshop empowered to ask questions, appreciate the process, and consider personalized goal-setting to meet the needs of current and future generations.

Dr. Erin Cortus, Associate Professor and Extension Engineer, University of Minnesota

Teaching Classroom

Culture of Success

COVID-19 changed the work environment and flexibility evolved to a workplace standard. This session will focus on the policy trends and staff training that have proven successful in building a culture of employee and company success.

Brittany King Asamoah, Attorney, Gislason & Hunter LLP

Synder Auditorium

Grain Market Outlook: A Discussion of the Key Market Drivers in Today's Volatile Global Grain Markets

StoneX is an institutional-grade financial services network that works to provide efficient market access and market intelligence to businesses of all sizes and in all industries. Join for a discussion on the key market drivers impacting global grain markets.

Natalie Benjamin, Senior Risk Management Consultant, StoneX Financial Inc.

Fireplace Room

There is No Prosthetic for a Bad Attitude

With the belief that there is no prosthetic for a bad attitude, Stephanie transitions her lifetime experience in the dairy industry into leadership lessons.

Stephanie Aves-Schroeder, Regional Sales Manager, Waikato Milking Systems

BREAKOUT II: 2:00 pm – 2:50 pm

MacMillan Auditorium

Know Your Numbers, Know Your Options

Agricultural producers are experiencing a challenging period of volatile commodity prices, trade uncertainty, weather issues, and lower farm revenues. In response to these challenges, an Annie's Project curriculum called Know Your Numbers, Know Your Options has been developed. Know Your Numbers, Know Your Options is a 4-week course designed to educate women farmers and farm women on using their financial records to more effectively navigate these times.

Dr. Karisha Devlin, Co-CEO, Annie's Project Education for Farm Women (APEFW)

Azalea Classroom

Plant-based Meat Alternatives and Cell-based Meat Products: Consumer Trends, Regulatory Implications

The rapid-fire growth of plant-based meat alternatives in the past several years and the development of cell-based meat products is top of mind for many in the food and ag industry. Take a closer look at the products being developed, market data on consumer demand, and the regulatory implications and challenges for these high-profile food products.

Alyssa Rebensdorf, Counsel, Faegre, Drinker, Biddle & Reath LLP

Teaching Classroom

Local is Where It's At!

Moore Farm and Moore Local are dedicated to local. Local food, local animals, local people. Heather believes in advocating for her community, with the motto "those who have the ability to serve their community have the obligation to do so." During this session learn how agriculture can make a difference in our local community and why it's important to build community partnerships.

Heather Moore, Owner, Moore Family Farms and Moore Local

Synder Auditorium

Playing Your Bigger Game:

Stepping Into Your Leadership Potential

Join this interactive session to gain the tools and opportunity to create a vision of where you want to be in 6 months, 12 months, 3 years. Take a look at where you are today and what you need or want to do to step up the game to achieve your vision and get to the next level of leadership.

Christine Pouliot, CEO, Evocent Leadership Development

Fireplace Room

Bend, Don't Break: Fostering Resilience in Times of Stress

When the stress of farming, relationships, and life start to overwhelm you, it's crucial to have strategies that help you cope. In this interactive session, we'll look at ways to help build resilience to get through difficult times and come out on the other side mentally and emotionally stronger.

Monica Kramer McConkey, Rural Mental Health Specialist, Eyes on the Horizon Consulting, LLC

CONFERENCE SPEAKERS

Stephanie Aves-Schroeder, regional sales manager, Waikato Milking Systems. She owns and operates ST-YLE Holsteins with her parents. With a lifetime in dairy, Stephanie's leadership extends from the farm throughout the industry. She has earned 30 Red and White All-American nominations as well as exhibited the 2008 Supreme Champion of the World Dairy Expo junior show and judged the 2021 World Dairy Expo Intermediate Showmanship Contest. Stephanie transitions her life experience into leadership lessons she shares.

Natalie Benjamin, senior risk management consultant with StoneX based in Alberta, Canada. Natalie obtained her Bachelor of Commerce degree in Energy Management from the University of Calgary and worked for a commodity risk management firm in Alberta prior to joining the StoneX team in 2016. Natalie's focus is the Know-Risk Crop Marketing program, working with producers in the Western Canadian grain and livestock industries to identify market risk, develop customized risk management strategies and execute risk management programs.

Natalie Cameron, assistant vice president credit officer at AgCountry. As a CPA, Natalie is drawn to the numbers and financial analysis. However, it is her passion for agriculture and rural America that brought her to AgCountry. She grew up in a military family, but northeast North Dakota has always been her "home." She lives on a small grains farm with her husband, Tyler, and their two busy little girls. In her free time, Natalie likes to be with family and friends, workout, and dream about a night of uninterrupted sleep.

Dr. Erin Cortus, associate professor and extension engineer in the Department of Bioproducts and Biosystems Engineering at the University of Minnesota. Her past and ongoing projects include measuring the air quality impacts of different manure management practices in poultry, swine, dairy and beef cattle barns, biosecurity, and sustainability metrics. The broad mission of Dr. Cortus' program is to work with producers and communities to understand and continually improve the quality and productivity of livestock environments.

Dr. Karisha Devlin, co-CEO at Annie's Project Education for Farm Women and a field specialist in Agricultural Business for the University of Missouri. She specializes in the areas of value-added agriculture, farm management, business development, and marketing. With her husband, Dan, they own and operate a grain farm along with raising two children who love farming and want to farm one day.

Mary Kay Delvo, owns INspiring SIGHT, a strategy, coaching and leadership development firm. Mary Kay's experience is deep and based on over 25 years working across sectors and large systems. She has been on the front lines as well as in the boardroom and understands that CEOs think differently than employees. Her clients are drawn to her direct, and transparent approach which combines a little dose of reality and humor. Organizations with the desire to evolve, grow and take risks view her as an asset.

Sarah Dornink, executive director, Minnesota Agricultural Education Leadership Council works to promote and expand agricultural education across the state. Sarah works with young agriculture leaders in many capacities such as being a National FFA Delegate Coordinator, advising the University of Minnesota Alpha Gamma Rho fraternity, and co-chairing and participating in the CFANS Mentor Program. She holds a BS and MS in Agricultural Education from the University of Minnesota.

Ben Hansen, career counselor and interim associate director, University of Minnesota Career Services. Ben supports students with career assessments, resumes, interviewing, and obtaining internships. He earned his BS in Business Management from St. Cloud State University. Ben's out of work obsession is travel and he has visited more international countries than US states.

Brittany King-Asamoah, attorney at Gislason & Hunter LLP, her legal practice focuses on employment law, agriculture law and civil litigation. She represents companies, farmers and agribusinesses in all areas of employment law, discrimination and general liability. She received her Juris Doctor, cum laude, from the University of Arkansas School of Law.

Nicole Koziolk, state secretary, Minnesota FFA Association inspires those who want to enter a career in agriculture and shares information and insights about agriculture and how the food system works. Koziolk's dream is to become an ag communicator, and continue her family corn and soybean farm operation. She is pursuing her degree in Agricultural Communication and Marketing at the University of Minnesota.

Monica Kramer McConkey, rural mental health specialist at Eyes on the Horizon Consulting, LLC, she has 25 years of experience in the behavioral health field. She focuses on increasing access to and removing the stigma often attached to mental health services. Monica grew up on a farm in northwestern Minnesota and has an understanding of the dynamics leading to farm stress and its impact on farm families. She is one of two Rural Mental Health Specialists in Minnesota providing support to farmers and their families.

Emily Krekelberg, extension educator for Farm Safety & Health at University of Minnesota Extension. Her work focuses on grain bin safety, livestock safety, tractor safety, farmer mental health, and suicide prevention. Her passion is advocating for wellness in agriculture. Emily grew up on her family's dairy farm near Le Sueur, MN. She has a BS in Animal Science and a MS in Agricultural Education from the University of Minnesota.

Jamie Logsdon, vice president agricultural credit analyst manager at U.S. Bank has a background in farm and cooperative financing and risk management with a passion for employee development, mentorship, and change leadership roles. She has a BS from Winona State University and an MBA from Saint Mary's University.

Doris Mold, agricultural consultant, agricultural economist, educator, advocate and catalyst as well as farm co-owner/operator. She is president of Sunrise Agricultural Associates, an agricultural consulting firm. Doris also teaches farm and ag business management at the University of Minnesota for MAST International.

Heather Moore, owner, Moore Family Farms and Moore Local, specializes in bringing local farm products to community consumers. Heather and her husband Brandon, along with their four children ages 12 to 3, and their partners, strive to make local food and local processing accessible to the farmers and communities in the Jackson County, Iowa area.

Veronica Nigh, senior economist, American Farm Bureau Federation is responsible for conducting research, policy analysis, and delivering information to AFBF members. Previously, Veronica worked for the USDA-FSA as an International Economist and served as an International Marketing Specialist at the Missouri Department of Agriculture. Veronica grew up on a small diversified livestock operation in Savannah, Missouri. She has a BS in Agricultural Economics from the University of Missouri and a Masters in Economics from American University.

Thom Petersen, appointed commissioner of the Minnesota Department of Agriculture in January 2019. Commissioner Petersen is a long-time resident of Royalton Township near Pine City where he lives on a horse farm. Petersen previously served as the Director of Government Relations for Minnesota Farmers Union since 2002, working on behalf of farmer-members in both Washington, D.C. and St. Paul, MN.

Christine Pouliot, CEO/owner of Evocent Leadership Development and a certified executive coach. She brings over 30 years of experience working with global information technology teams for a Fortune 20 company. Her specialties include working with individuals and leaders in the Science, Technology, Engineering and Math (STEM) fields, leaders growing into a global or new stretch role, or simply supporting executives through disruptive organizational change.

Alyssa Rebensdorf, counsel at Faegre, Drinker, Biddle & Reath LLP builds on two decades of experience to help food industry clients solve litigation and regulatory challenges. A core member of Faegre Baker Daniels' nationally recognized Food Litigation and Regulatory practice, she provides strategic counsel in post-recall litigation in state and federal courts nationwide and advises food industry clients on various risk management and compliance issues. She enjoys working with experts to translate complex medical and microbiological information for clients and fact finders alike.

Corey Scott, livestock services lead with Truterra, LLC, a division of Land O'Lakes Inc. works to connect livestock producers to regenerative ag solutions to further maximize the impact those solutions have on producer profitability, sustainability, and long-term growth. She has worked throughout the Land O'Lakes enterprise with a focus on producer risk management and on-farm business consulting. Corey and her husband Darren raise horses in Scandia, MN.

Jennifer Webster, protein trader at CHS Inc. became interested in commodity marketing at a young age helping her dad track grain prices online. She started her career at CHS as a grain marketing intern in South Dakota and then completed their training program focused on learning commodity trading in different business units working in North Dakota and the CHS corporate office where she has since held multiple commodity marketing roles.

MINNESOTA LANDSCAPE ARBORETUM LEON C. SNYDER BUILDING MAP

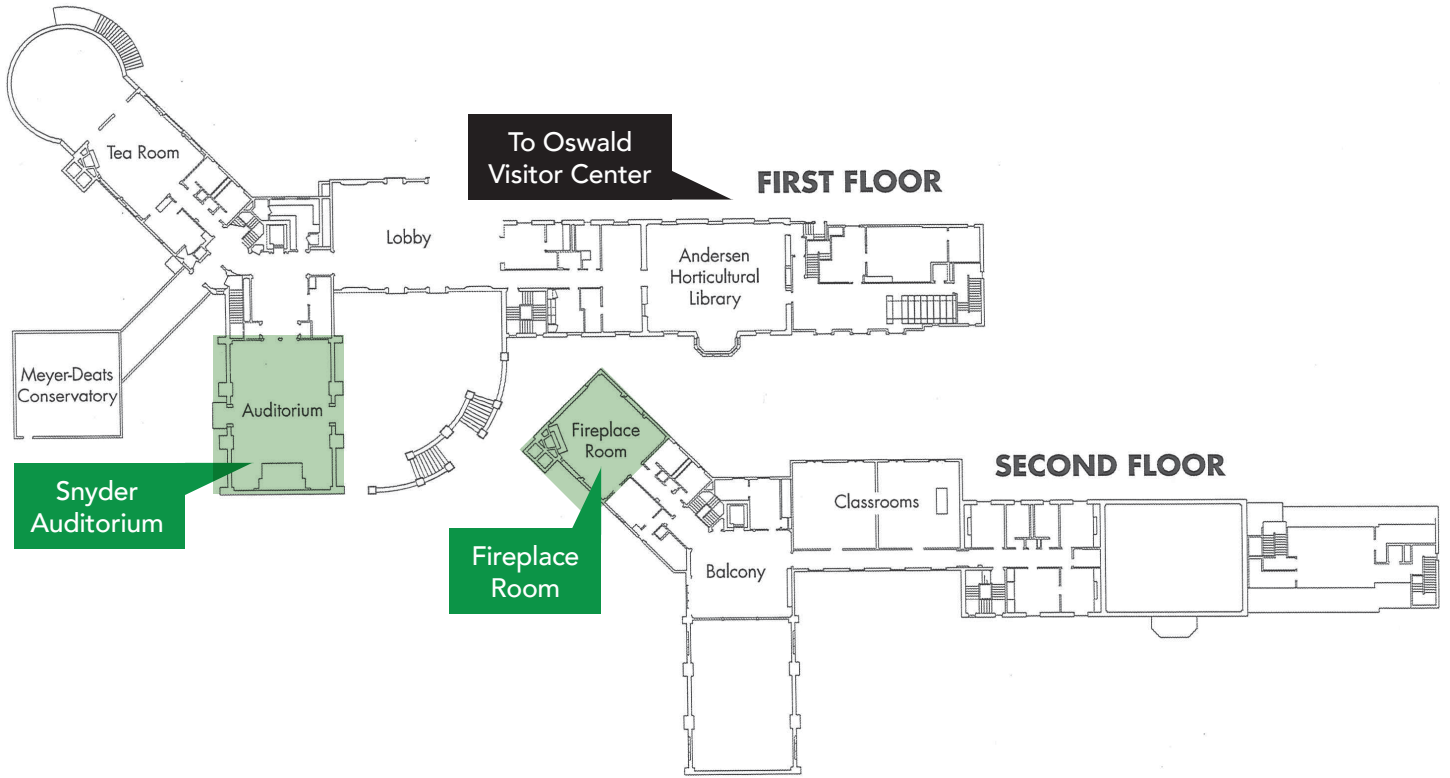

MINNESOTA LANDSCAPE OSWALD VISITOR CENTER MAP

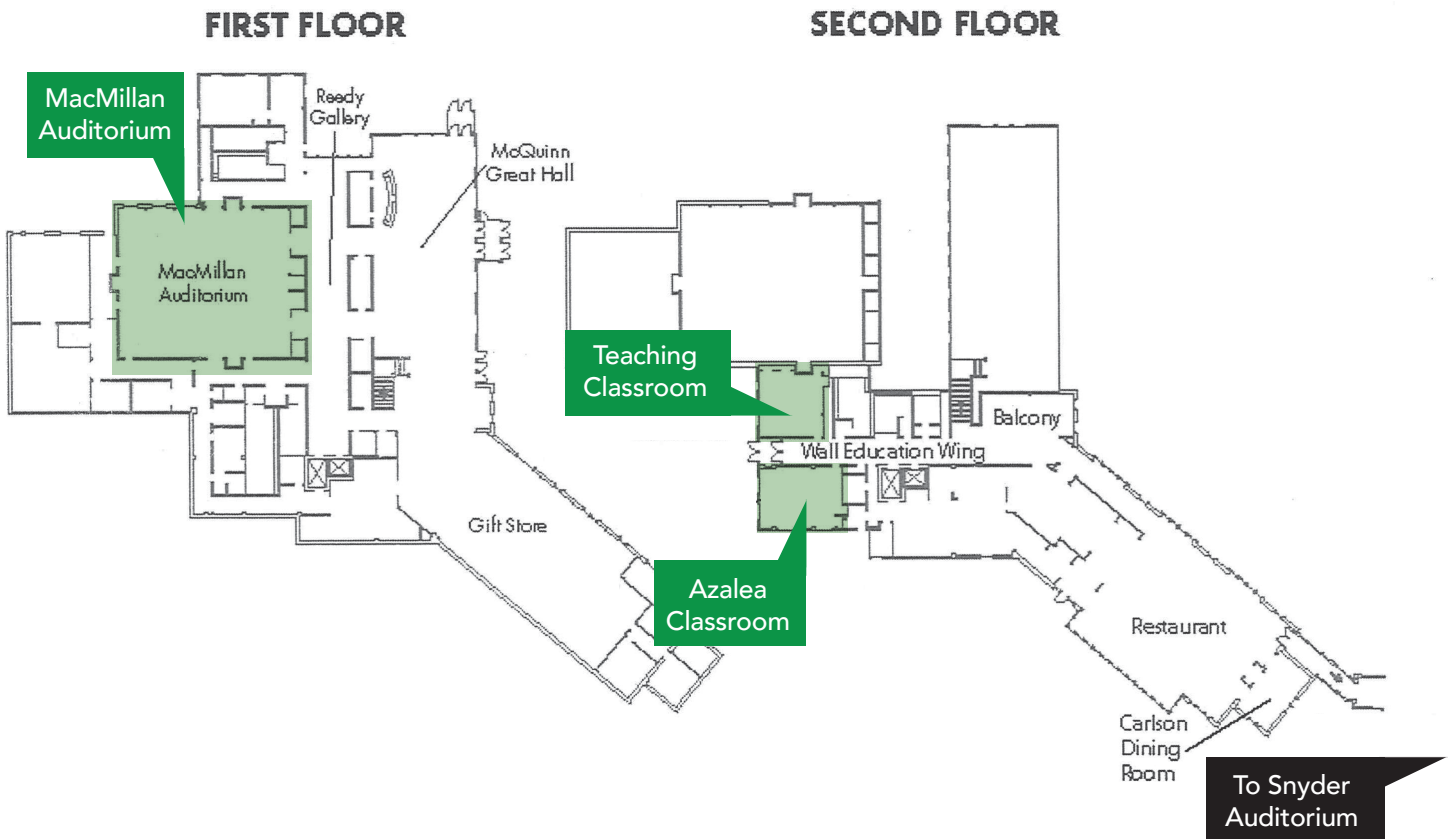

WOMEN'S AGRICULTURAL LEADERSHIP CONFERENCE 2022

2022 WALN VIRTUAL EVENTS

May 4th at Noon CT:

2022 Conference Follow-up
Continuing the conversation and connections for those who attended in-person and virtually

FUTURE QUARTERLY WALN EVENTS

June 1st at noon CT

September 7th at noon CT

December 7th at noon CT

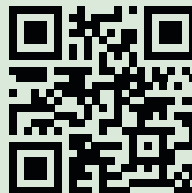

SCAN QR
CODE FOR
REGISTRATION
DETAILS

PAST CONFERENCE THEMES

2021: Leading for Change into a New Decade

2020: Dare to Lead: Through Challenging Circumstances

2019: Changing the Agscape

2018: Passion for Progress

2017: Embracing Innovation

2016: Activate Her

2015: Planning Our Future

2014: Lean In!

2013: You Ain't Seen Nothing Yet!

2012: Changing the Face of Agriculture

2011: Telling Our Story

2010: New Perspectives

2009: Activating "Generation Next"

2008: Celebrating the Power of 10

2007: Deciphering Our Future

2006: Re-Defining Agriculture

2005: The Power of Leadership

2004: Breaking New Ground

2003: We are the Strongest Link

2002: Together We Stand

2001: Creating Your Future in Agriculture

2000: Empowering Yourself for the Future

1999: Making Our Place in the World

2022 COMMITTEE MEMBERS

Doris Mold (Co-Founder)*

Ashley Craft

Amanda Durow*

Sarah Dornink*

Caitlin Keck*

Margaret Hart*

Emily Krekelberg*

Mackenzie Lewis

Isabelle Lindahl

Jamie Logsdon

Kristine Schechinger (intern)

Sam Schwoeppe

Corey Scott

Yvonne Simon*

Kris Schmitt*

Greta Tank

Molly VanBrocklin (graphic designer)

Sue VonBank*

*Indicates 5+ year committee volunteer

WWW.WOMENSAGLEADERSHIP.ORG



Like our page
on Facebook
/womensagleadership



Follow us
on Instagram
@womensagleadership



Use the hashtag
#WALC2022 on Twitter
@womensaglead

Thank you to all of our 2022 Sponsors!

— Innovator Sponsorship Partner ————— Major Sponsorship Partners —



————— Key Sponsorship Partners —————



————— 2022 Conference Partners —————

AgCountry Farm Credit Services
Agricultural Computing and Consulting
American Farm Bureau Federation
CoBank
Compeer Financial
District 11 Agri-Women
Doris Mold Agricultural Consulting
Farm Credit Leasing
Farm Fresh Designs
Fresh Flower Designs
Land O'Lakes, Inc.

Minnesota Department of Agriculture
Minnesota Farm Bureau Foundation
Minnesota Farmers Union
Minnesota State Fair
Minnesota State Southern Agricultural Center of Excellence
StoneX
Sunrise Agricultural Associates, LLC
University of MN Collegiate Agri-Women
Upper Midwest Agricultural Safety and Health Center (UMASH)
Women's Agricultural Leadership Foundation

**A BIG THANK YOU
TO OUR SPEAKERS
AND VOLUNTEERS!**



**THANKS FOR ATTENDING!
PLEASE SCAN THIS QR
CODE TO TAKE A SURVEY**

WWW.WOMENSAGLEADERSHIP.ORG



Like our page
on Facebook
[/womensagleadership](https://www.facebook.com/womensagleadership)



Follow us
on Instagram
[@womensagleadership](https://www.instagram.com/womensagleadership)



Use the hashtag
#WALC2022 on Twitter
[@womensaglead](https://twitter.com/womensaglead)